



K1 SECTION THROUGH GOLF VILLAS
SCALE: 1/8" = 1'-0"

A1 NOT USED
SCALE: NA

ARCHITECT OF RECORD - RESORT

J|f Jensen Fey
PHONE 425.216.0318 FAX 425.216.0329
7730 Cary Way, Redmond, WA 98052

ARCHITECT OF RECORD - RESIDENTIAL

MINNO & WASKO
ARCHITECTS AND PLANNERS
1614 WEST LANE, SUITE 105
LAMBERTVILLE, NJ 07839
TEL: (908) 961-8666
FAX: (908) 961-7543

SURVEY, PLANNING AND ENGINEERING

CHAZEN ENGINEERING, LAND SURVEYING
LANDSCAPE ARCHITECTURE CO., P.C.

Principal: Charles Chazen
Principal: Robert Chazen
Principal: Robert Chazen
Principal: Robert Chazen

GOLF COURSE ARCHITECT

ERNIE ELS DESIGN
1001 GOLF COURSE DRIVE, SUITE 100
LYNN, FLORIDA 32909-5014, USA

NATURAL RESOURCE MANAGEMENT PLAN
AUDUBON INTERNATIONAL
P.O. BOX 1225
CARY, NC 27512

WATER AND WASTEWATER TREATMENT FACILITIES
DELAWARE OPERATIONS, INC
6-12 CHESTER ST., SUITE 300
ORADONKA, NY 13829
TEL: (847) 432-8873

NOTES:

No.	ISSUE	DATE
1	MASTER DEVELOPMENT PLAN	04-03-08

KEY PLAN NOT FOR CONSTRUCTION

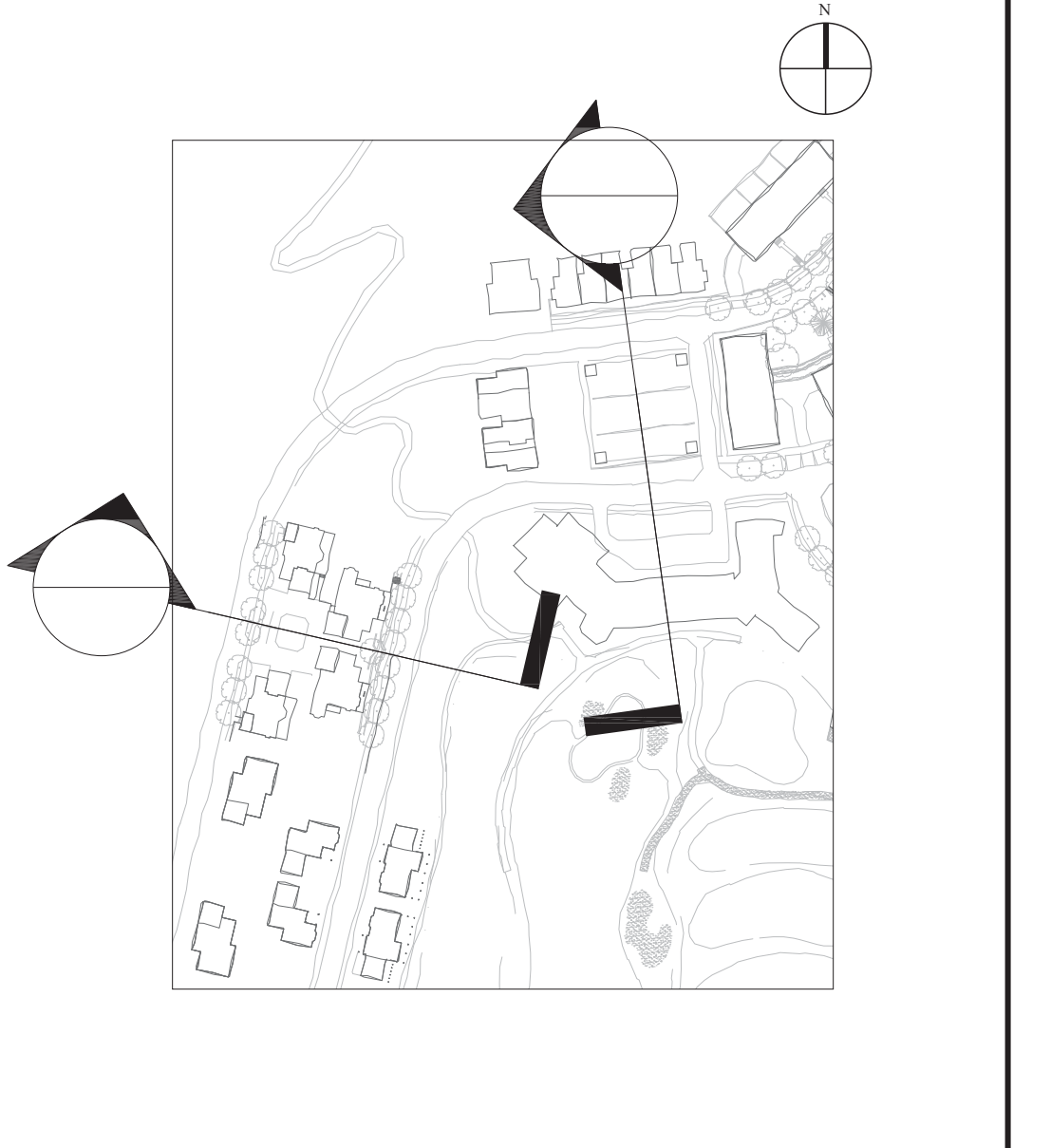

SILO RIDGE RESORT COMMUNITY
AMENIA, NY

ROBERT A.M. STERN ARCHITECTS, LLP
460 WEST 34th STREET, NEW YORK, NY 10001
TEL (212) 967-5100 • FAX (212) 967-5588

HIGHER GROUND COUNTRY CLUB MANAGEMENT CO., LLC
SILO RIDGE COUNTRY CLUB
P.O. BOX 86
AMENIA, NY 12501

SITE SECTION
PHASE I - GOLF VILLAS

Project No.	Date
CAD File No.	Scale
Drawing No.	

SP-16